

BUILT-IN MICROWAVE OVEN

USER MANUAL

MW 25 DI X

Warning notices: Before using this product, please read this manual carefully and keep it for future reference. The design and specifications are subject to change without prior notice for product improvement. Consult with your dealer or manufacturer for details.
The diagram above is just for reference. Please take the appearance of the actual product as the standard.

Installation Instructions

Please Read the Manual Carefully Before Installation

Please note

Electricalconnection

The oven is fitted with a plug and must only be connected to a properly installed earthed socket. The socket must only be installed and the connecting cable must only be replaced by a qualified electrician, and in accordance with the appropriate regulations. If the plug is no longer accessible following installation, an all-pole isolating switch must be present on the installation side with a contact gap of at least 3 mm.

The fitted cabinet must not have a back wall behind the appliance.

A gap must be maintained between the wall and the base of the unit above.

Specific gap size could be referenced by the diagrams.

Minimum installation height: 85 cm.

Do not cover ventilation slots and suction holes.

NOTE

Do not trap or bend the power cable.

In case of any differences between the appliance and the pictures in this manual, the product shall prevail.

 Screw

 Mounting Plate

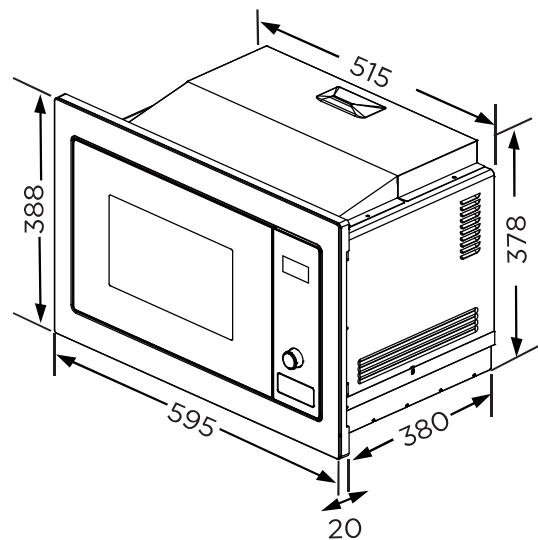

A. Built-in Furniture

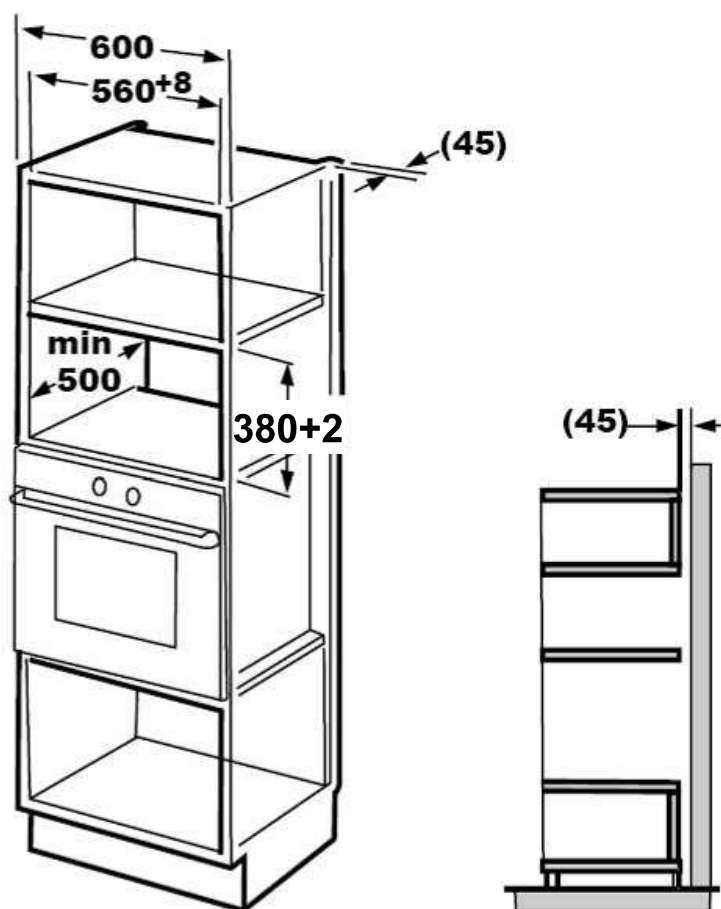

B. Prepare The Cabinet

- Read the instruction on the BOTTOM CABINET TEMPLATE, put the template on the bottom plane of cabinet.

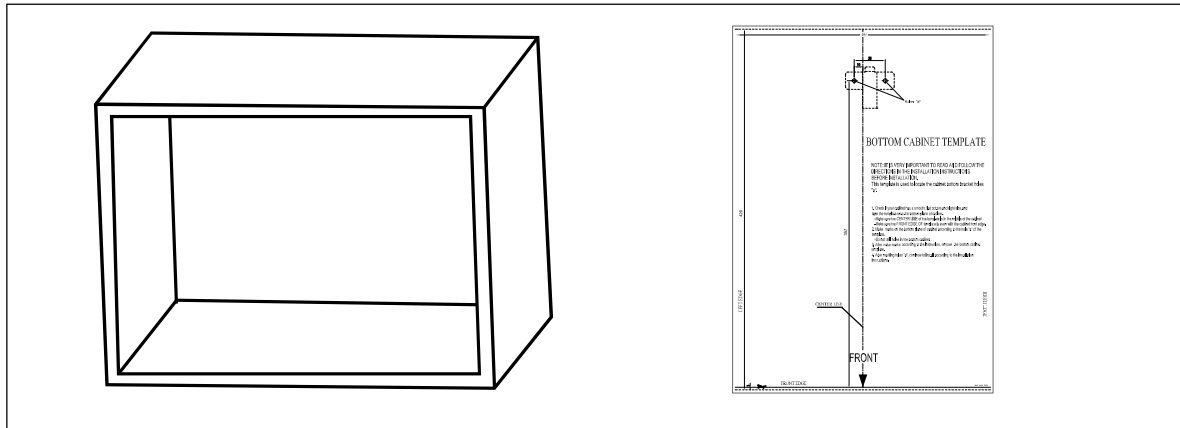

- Make the marks on the bottom plane of cabinet according to marks "a" of the template.

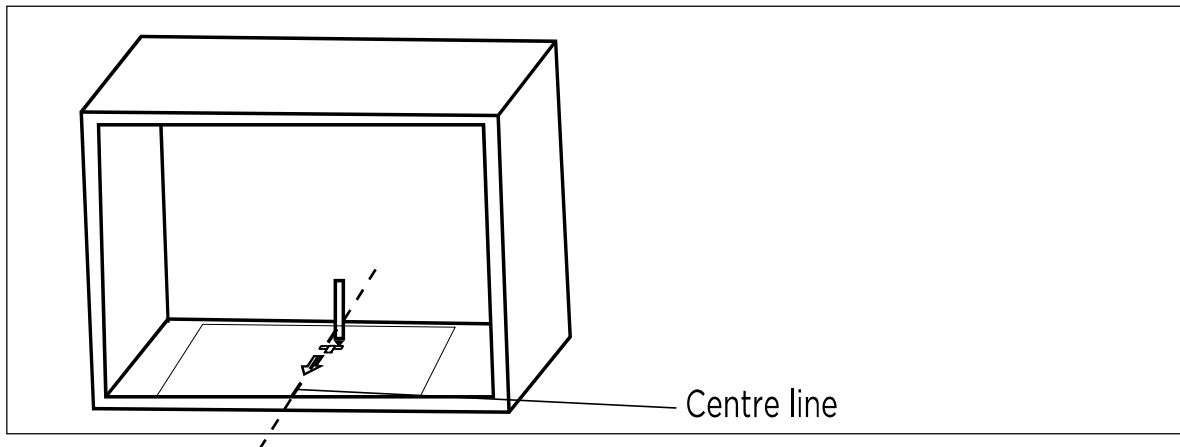

- Remove the bottom cabinet template and fix the mounting plate with screw.

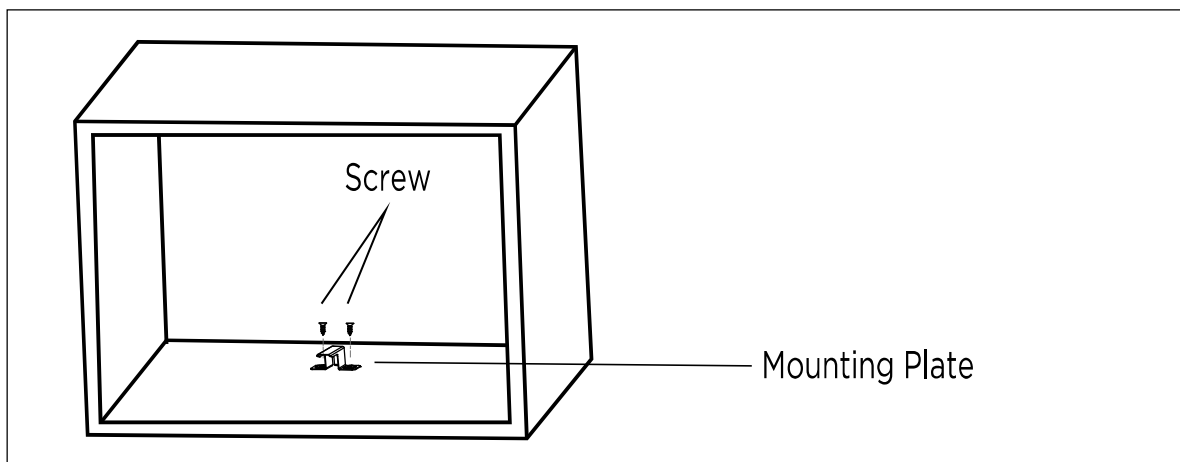

C. Install The Oven

- Install the oven to the cabinet
 - Make sure the back of the oven is locked by mounting plate .
 - Do not trap or kink the power cord.

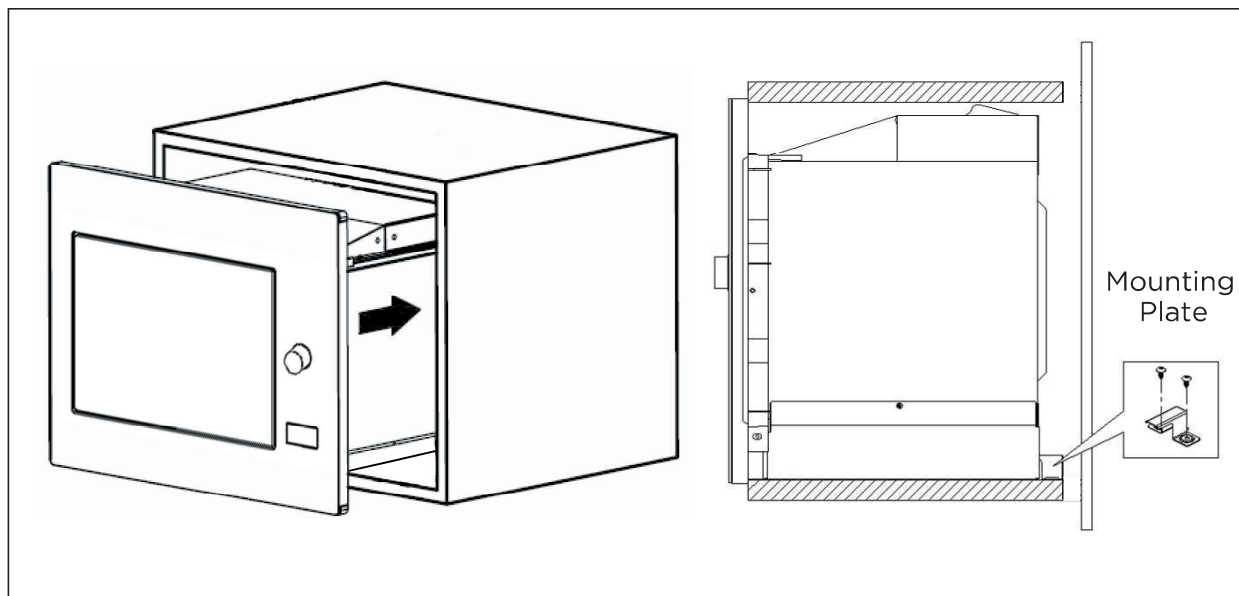

- Open the door, fix the oven to the cabinet with Screw, at the installation hole.

